

The LE75 System comprises a Relay Module and a Wall Control with 6 dip switches for different air conditioning setups. Locate Wall Control Pad on an internal flat wall surface approximately 1.5 meters above floor level to sense room temperature. Avoid drafts or locating in direct sunlight, similar considerations should apply to a remote sensor. See Page 2 for wiring.

DIP SWITCH SETTINGS

| LE75 | OFF | ON | LE75V |
|-------|----------------------------|------------------------------|-------|
| SW1.1 | Cool/Electric(other)Heat | Heat Pump(Rev Cycle) | SW1.1 |
| SW1.2 | Fan Auto | Fan Continuous | SW1.2 |
| SW1.2 | Three Speed Fan | Single Speed Fan(HIGH Relay) | SW1.3 |
| SW2.1 | Reversing valve on in Heat | Reversing valve on in Cool | SW1.4 |
| SW2.2 | One stage Heat and Cool | Two stages of Heat or Cool | SW1.5 |
| SW2.3 | Two stages of Heating | Two stages of Cooling | SW1.6 |

LE75
Rear View of Wall Control

POWER
SENSOR
AUX
COMMON

Dip switches

SW1 ON 1 2 3

SW2 ON 1 2 3

Link

LE75V
Rear View of Wall Control

POWER
SENSOR
AUX
COMMON

Dip switches

SW1 0 1 2 3 4 5 6

Link

| SPECIFICATIONS | |
|---|----------------------|
| Power supply | 240 Volts 50Hz |
| Relays. Five SPST volt free contacts | 12 amps Res @ 250vac |
| Set point operating range | 12oC to 32oC |
| Dead band. From Heating off to Cooling on | 1.5K |
| Switching differential | 0.5oC |
| Fan run on - Electric heating only | 30 secs |
| One volt free auxiliary input supplied by others for remote start and stop. | |
| Integral Sensor (or optional remote sensor) | 10K @ 25oC |

| COMMISSIONING and SERVICE KEYS |
|--|
| <p>To display high resolution temperature. Press and Hold FAN button press ON button and release both. Temperature reads in increments of 0.1oC. E.g 2.5=22.5 (MID led on) Fan Leds give you the range i.e. HIGH = 30's, MID = 20's, LOW = 10's Press any button to return controller to normal operation.</p> |
| <p>To reset Controller to Factory Default settings. Turn off power, hold ON button, turn on power.</p> |



LED INDICATORS

| | | | | |
|---------------------|------|---------------------------------|---------------------------------|----------------------------|
| MAXIMUM FAN SPEED → | HI | <input type="checkbox"/> RED | <input type="checkbox"/> ORANGE | ← AUTO ← AUTOMATIC MODE |
| MEDIUM FAN SPEED → | MID | <input type="checkbox"/> ORANGE | <input type="checkbox"/> RED | ← HEAT ← HEATING OPERATION |
| MINIMUM FAN SPEED → | LOW | <input type="checkbox"/> GREEN | <input type="checkbox"/> GREEN | ← COOL ← COOLING OPERATION |
| CONTINUOUS FAN → | CONT | <input type="checkbox"/> ORANGE | <input type="checkbox"/> RED | ← TIMER ← TIMER ACTIVATED |

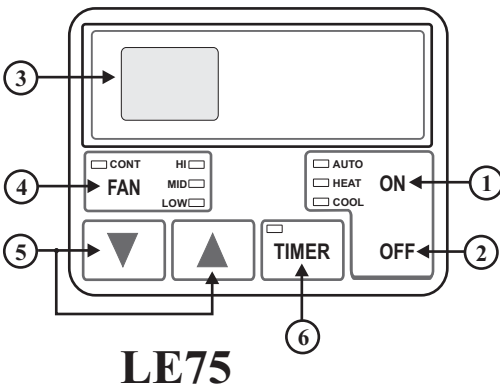

LE75 OPERATING INSTRUCTIONS

- ① Press the ON button to start the air conditioning system
 AUTO mode will automatically select heat or cool depending on temperature.
 Press ON again to select HEAT, the system will operate in heat mode only.
 Press ON again to select COOL, the system will operate in cool mode only.
 Press ON again to go back to AUTO thermostat mode.
- ② Press OFF button to stop the air conditioning system.
- ③ Display temperature SETPOINT i.e. desired temperature setting.
- ④ Press FAN button to select fan speed, keep pressing FAN to cycle through fan settings i.e. HIGH, MID, LOW, CONT HIGH, CONT MID, CONT LOW.
 CONT stands for continuous operation of the fan, usually used in cooling mode.
- ⑤ Press and hold UP or DOWN arrow to select the desired temperature setting
- ⑥ Press the TIMER button to activate the delay timer.
e.g. before going to bed press TIMER, while it is flashing press UP or DOWN button to set 2.0 then the air conditioning system will stop after 2 hours.
If the system is ON, set TIMER to STOP the system after the set duration.
If the system is OFF, set TIMER to START the system after the set duration.

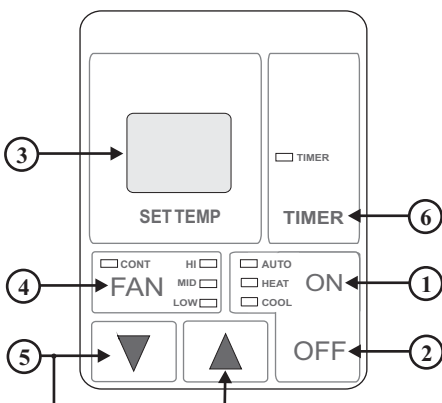

DISPLAY ROOM TEMPERATURE

"Quick Press" UP button to display the room temperature for 3 seconds.

VENTILATION MODE

With the system off, Press the FAN button to circulate the air.
 Press OFF to STOP the fan.

Reverse cycle air conditioning system.

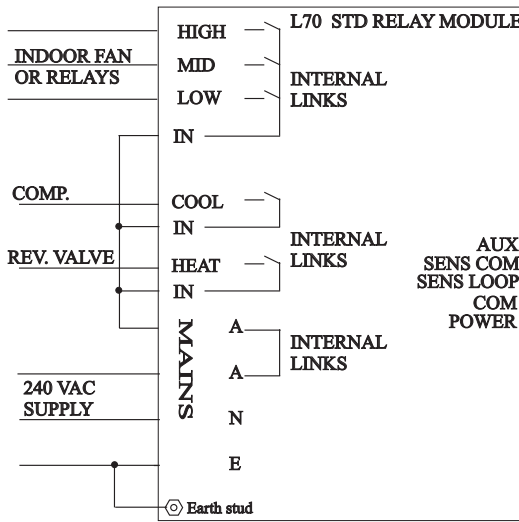

Reverse cycle air conditioning system.
24 vac control system

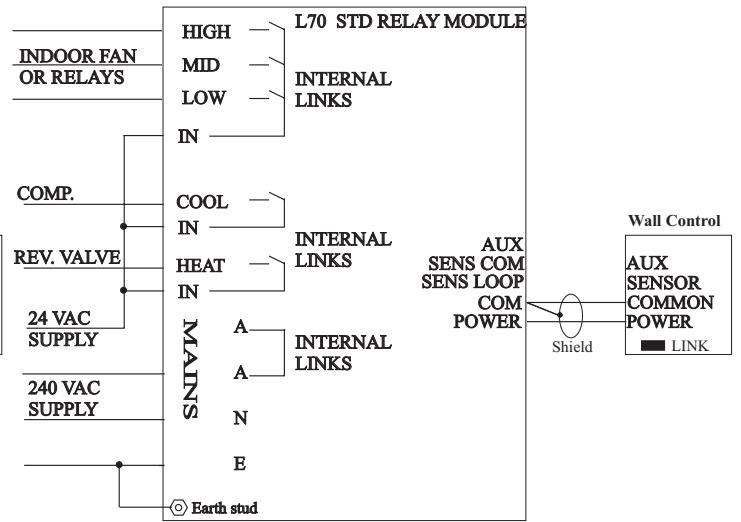

Reverse cycle air conditioning system.
Remote sensor. Remove link from rear of Wall Control Pad.

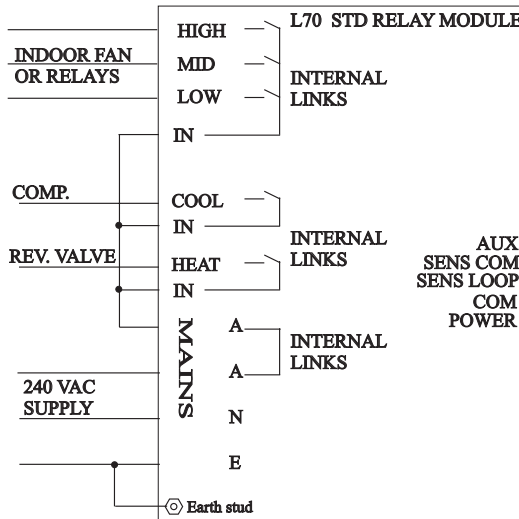

DODC Chilled water valve and electric duct heater.
Remote stop/start and sensor.
Remove link from rear of Wall Control Pad.

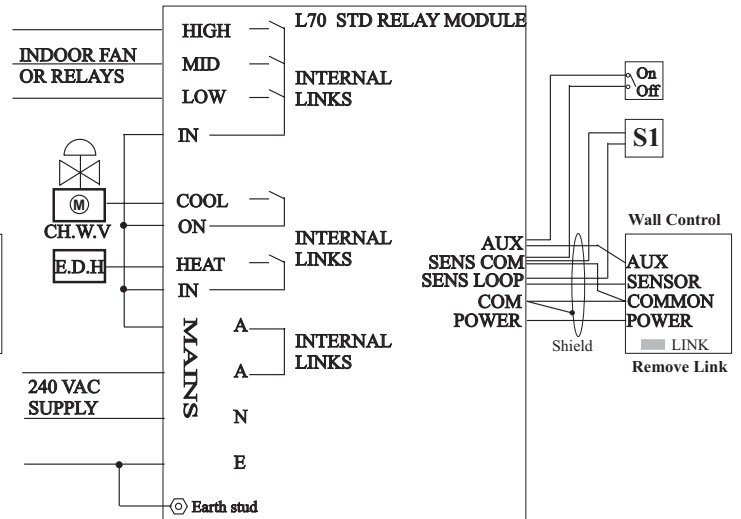

Two stage cooling.
Single speed fan.

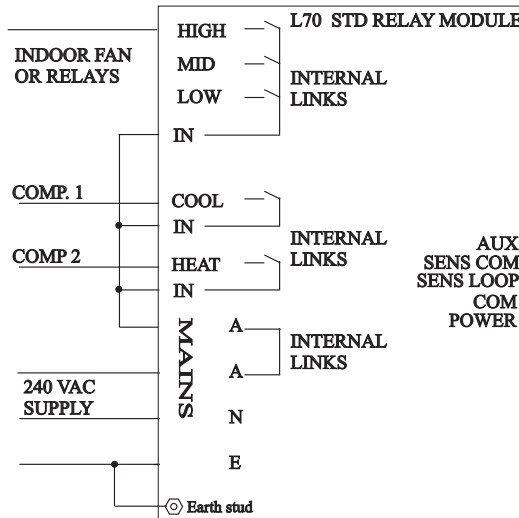

Two stage heating.
3 speed fan

